

oakheart

£1,725 Per Month

Per Month

Drumlin Drive, Creeping St. Mary

Available now, this beautifully designed four-bedroom detached home is located in the sought-after village of Creeting St Mary, in the heart of the Suffolk countryside. Part of the exclusive Alder Meadow development by Redbourne Homes, the property combines contemporary living with characterful design, finished to a high standard throughout.

The ground floor offers a spacious open-plan kitchen and dining area with French doors opening directly onto the garden, perfect for modern family living and entertaining. A separate study provides an ideal space for home working, while the generous living room benefits from a second set of French doors, flooding the room with natural light and offering direct access to the garden.

Upstairs, the master bedroom boasts an en suite shower room, accompanied by three further well-proportioned bedrooms and a family bathroom.

The property further benefits from private parking and is ideally situated just a 7-minute drive from Needham Market, offering excellent transport links to Ipswich, London, Bury St Edmunds and Cambridge.









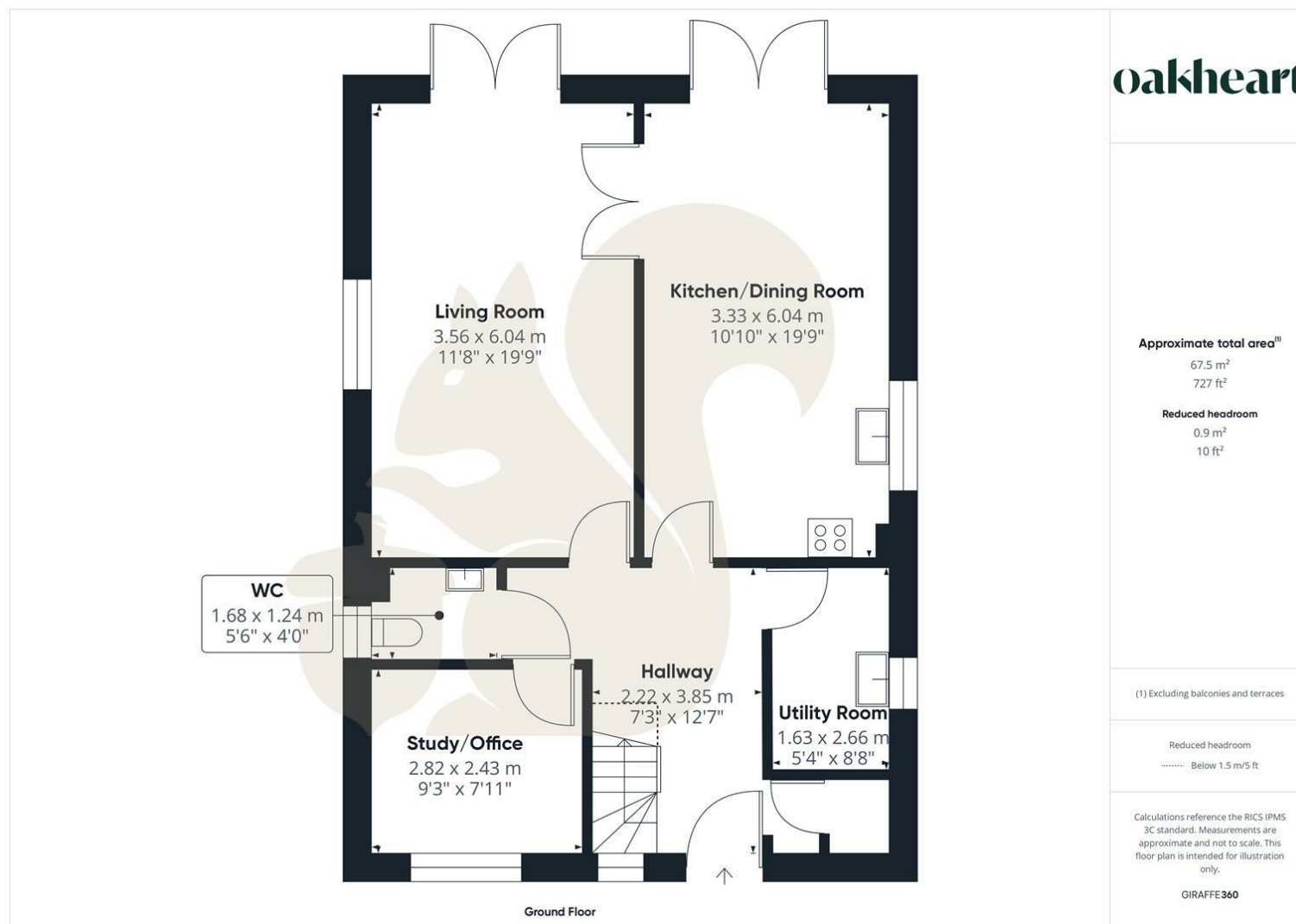

Local Authority:

Tenure:

Council Tax Band:
New Build

Energy Efficiency Rating		
	Current	Potential
Very energy efficient - lower running costs		
(92 plus) A		
(81-91) B		
(69-80) C		
(55-68) D		
(39-54) E		
(21-38) F		
(1-20) G		
Not energy efficient - higher running costs		
England & Wales	EU Directive 2002/91/EC 	

Agents Note: Whilst every care has been taken to prepare these particulars, they are for guidance purposes only. All measurements are approximate and are for general guidance purposes only and whilst every care has been taken to ensure their accuracy, they should not be relied upon.